

## Wing

Michael Koenig 2009

**FLORA** 



The Wing modular systems consists of separate elements which are interlinked, and this ensures individual lines. Many aspects of the Wing modules, which are of differing heights, can be individualised. By using integrated lighting, coloured panes, plants or a specific pattern, it is possible to create new and exciting structures which satisfy individual requirements.

**FLORA Wilh. Förster**  
GmbH & Co. KG

Schmidtsiepen 3  
58553 Halver  
Germany

Phone +49 (0)2353 9117-0  
Fax +49 (0)2353 9117-17  
E-Mail [info@flora.biz](mailto:info@flora.biz)  
Internet [www.flora.biz](http://www.flora.biz)

## Wing

Michael Koenig 2009

# FLORA

Wall system for structuring landscapes and outdoor rooms, aluminium sheet, powder coated in white, hot-dip galvanised steel base, three sizes, optional colour filter

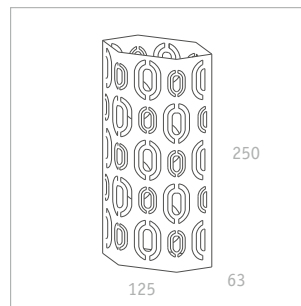

Wing 250  
Weight 56 kg

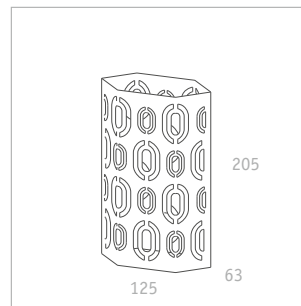

Wing 200  
Weight 49 kg

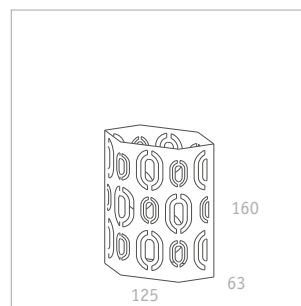

Wing 160  
Weight 42 kg

**FLORA Wilh. Förster**  
GmbH & Co. KG

Schmidtsiepen 3  
58553 Halver  
Germany

Phone +49 (0)2353 9117-0  
Fax +49 (0)2353 9117-17  
E-Mail [info@flora.biz](mailto:info@flora.biz)  
Internet [www.flora.biz](http://www.flora.biz)

## Wing

Michael Koenig 2009

**FLORA** 

Wall system for structuring  
landscapes and outdoor rooms,  
aluminium sheet, powder  
coated in white, hot-dip  
galvanised steel base, three  
sizes, optional colour filter

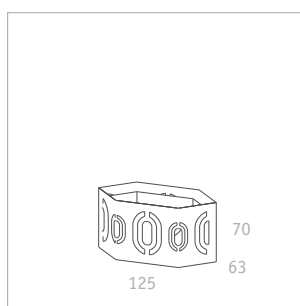

Wing 70  
Volume planter 250 l  
Weight 39 kg



**FLORA Wilh. Förster**  
GmbH & Co. KG

Schmidtsiepen 3  
58553 Halver  
Germany

Phone +49 (0)2353 9117-0  
Fax +49 (0)2353 9117-17  
E-Mail [info@flora.biz](mailto:info@flora.biz)  
Internet [www.flora.biz](http://www.flora.biz)

## Wing

Michael Koenig 2009

**FLORA** 

Wall system for structuring landscapes and outdoor rooms, aluminium sheet, powder coated in white, hot-dip galvanised steel base, three sizes, optional colour filter

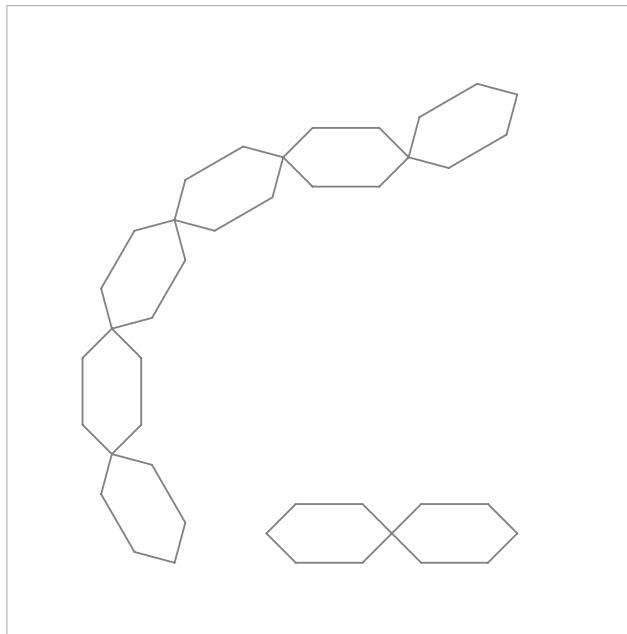

Flexible angle to arrange the different high elements in lines. After set up they connected together



Standard flagstone as weight covered by zinc plated sheet

**FLORA Wilh. Förster**  
GmbH & Co. KG

Schmidtsiepen 3  
58553 Halver  
Germany

Phone +49 (0)2353 9117-0  
Fax +49 (0)2353 9117-17  
E-Mail [info@flora.biz](mailto:info@flora.biz)  
Internet [www.flora.biz](http://www.flora.biz)

## Wing

Michael Koenig 2009

**FLORA** 

Wall system for structuring landscapes and outdoor rooms, aluminium sheet, powder coated in white, hot-dip galvanised steel base, three sizes, optional colour filter



Colour filter fixed in rail top and bottom. Colours on request

Possible to illuminate by standard outdoor spotlight



**FLORA Wilh. Förster**  
GmbH & Co. KG

Schmidtsiepen 3  
58553 Halver  
Germany

Phone +49 (0)2353 9117-0  
Fax +49 (0)2353 9117-17  
E-Mail [info@flora.biz](mailto:info@flora.biz)  
Internet [www.flora.biz](http://www.flora.biz)

## Wing

Michael Koenig 2009

**FLORA** 



### Roof terrace, Como

The two-storey multi-section roof terrace in the centre of Como is surrounded by houses. Several groups of Wing elements give protection against inquisitive glances. The flexible arrangement of the systems permits the ingenious utilisation of free spaces.

There is an uninterrupted view over the roofs as far as the surrounding mountains, and the light from the setting sun shines deep through the large front window.

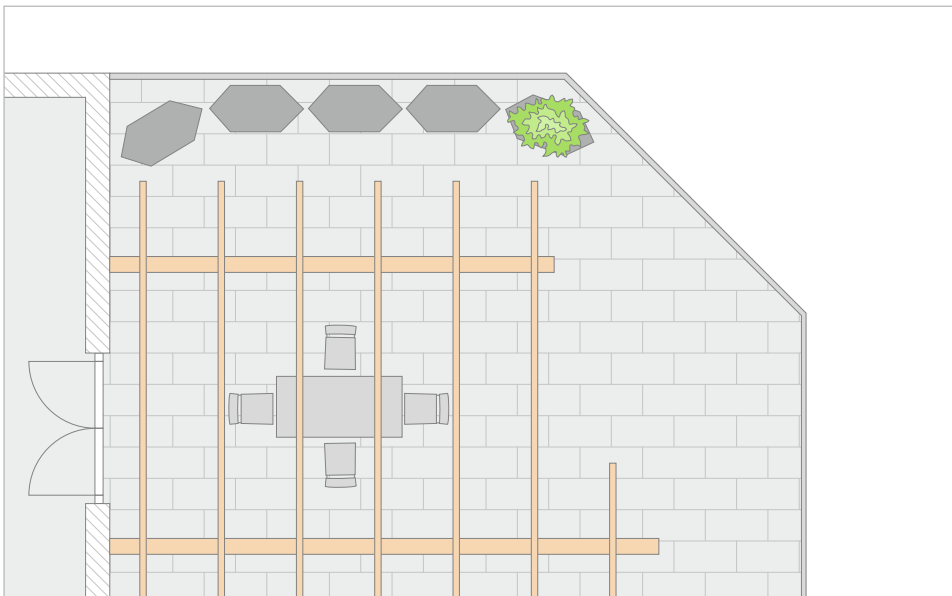

**FLORA Wilh. Förster**  
GmbH & Co. KG

Schmidtsiepen 3  
58553 Halver  
Germany

Phone +49 (0)2353 9117-0  
Fax +49 (0)2353 9117-17  
E-Mail [info@flora.biz](mailto:info@flora.biz)  
Internet [www.flora.biz](http://www.flora.biz)